

## Model AKIC200 Ironing Center with Directional Light and Door Included

**WARNING:** INSTALLATION BY A LICENSED ELECTRICIAN IS RECOMMENDED. INSTALLATION AND USE OF THIS EQUIPMENT SHOULD BE IN ACCORDANCE WITH PROVISIONS OF THE NATIONAL ELECTRICAL CODE, APPLICABLE LOCAL CODES AND PERTINENT INDUSTRY STANDARDS.

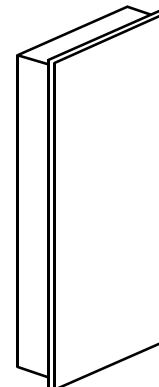

### Installation Instructions

1. Before starting installation, choose a location that will allow enough room for the cabinet door to open fully (door width is 16") and for the ironing board to fully extend out of the cabinet.
2. Use chart below, determine the desired height of board and make cut into wall between 16" on center studs 143/8" x 47" x 4". If studs are not 16" o.c., a rough-in opening needs to be framed to fit the unit.

MOUNTING HEIGHT ABOVE FLOOR LEVEL	
Desired Board Height	Mount Cabinet Above Floor
36"	30"
35"	29"
34"	28"
33"	27"
32"	26"
31"	25"
30"	24"
29"	23"
28"	22"

**WARNING:** Make sure to identify any electrical, plumbing or other possible obstruction inside the wall before making cuts to avoid personal risks and damage.

3. Attach a 2" x 4" cleat to studs level with bottom of opening. Make sure cleat is level.

**WARNING:** Make sure power is turned off at service panel before starting installation or servicing.

4. Remove the wiring compartment and feed electrical supply wire through knockout at the top of the unit, allowing enough wire to make all connections.
5. Connect Black (hot) wire from house to black wire of unit. Connect White (neutral) wire from house to white wire of unit. Connect supply ground wire to provided grounding screw and reinstall wire compartment.
6. Insert Cabinet into opening. Plumb cabinet and shim to fit. Sidewalls must fit snugly against studs.

**NOTE:** if the door does not close properly, the unit is not fully plumbed. Readjust with shims and check level again.

7. Once cabinet is plumbed, attach to studs with 11/2" x 1/4" lag screws through the 6 predrilled holes.
8. The door provided with unit is an unfinished wood door and can be painted or stained.

### Operating Instructions

1. To operate unit, open door and release retaining wire holding board.
2. An electric outlet is provided inside the unit to be used with an iron. The switch is powered by turning the Timer Switch on the electrical panel. An Indicator Light will turn on when there is power to the Outlet. (Fig. 1)
3. Your unit is equipped with an adjustable light that uses a R20/30W, 30 Watt maximum bulb (not included) and an Automatic Shut-Off Switch that turns the power to the control panel OFF when the ironing board is in the upright position. (Fig. 1)

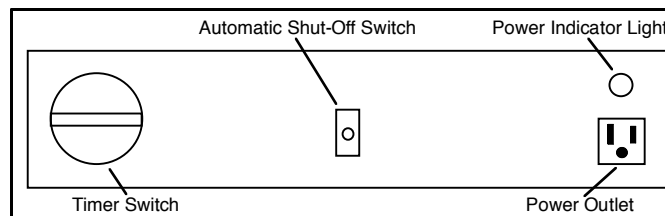

Fig. 1

**WARNING:** A shelf located at the top of the unit is provided for storage of an iron only. Before returning iron to storage shelf, unplug and allow to cool.

### Warranty

Your Air King Ironing Center is warranted for one (1) year from the date of purchase against defects in workmanship and/or material.

This warranty does not cover any labor or shipping costs or the cost of replacement components as part of routine maintenance. As well, any damage or failure caused by abuse, misuse, abnormal usage, faulty installation, or improper maintenance will not be covered by this warranty.

In order to make a claim on this warranty, you must be the original consumer of the product, and you must contact Air King Ltd. at 1-877-304-3785 between 8:00 am and 3:30 pm EST Monday to Friday at the first sign of defect. You will be required to present to Air King Ltd. the original bill of sale showing: date of purchase, place of purchase and model purchased. Failure to meet these requirements will void your warranty.

Air King Ltd. will not be held responsible for any bodily injury or damages to personal property or real estate whether caused directly or indirectly by the product. Some states and provinces do not allow the exclusion or limitation of incidental or consequential damages and some states do not allow limitations on how long an implied warranty lasts, so these exclusions or limitations may not apply to you. This warranty gives you specific legal rights and you may have other rights which vary from state to state and province to province.