

**Power Unit Insert Liners**  
 Use with Air King model SEV24SS

• **Dimensions**

**HL300S:** Overall bottom projection - 29<sup>11</sup>/<sub>16</sub>"  
 Overall top projection - 17<sup>7</sup>/<sub>8</sub>"  
 Height - 4"

**HL360S:** Overall bottom projection - 35<sup>11</sup>/<sub>16</sub>"  
 Overall top projection - 17<sup>7</sup>/<sub>8</sub>"  
 Height - 4"

**HL30RS:** Overall bottom projection - 27"  
 Overall top projection - 21"  
 Height - 3<sup>1</sup>/<sub>2</sub>"

**HL36RS:** Overall bottom projection - 33"  
 Overall top projection - 21"  
 Height - 3<sup>1</sup>/<sub>2</sub>"

• **Body**

24 Gauge Stainless Steel

• **Power Unit Opening**

Width: 10<sup>3</sup>/<sub>32</sub>"  
 Depth: 10<sup>3</sup>/<sub>32</sub>"

• **Shipping Info**

Box Dim: -  
**HL300S:** UPC 0-8316238101-9  
**HL360S:** UPC 0-8316238111-8  
**HL30RS:** UPC 0-8316238001-2  
**HL36RS:** UPC 0-8316238011-1

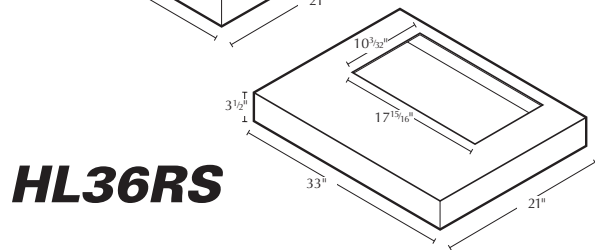
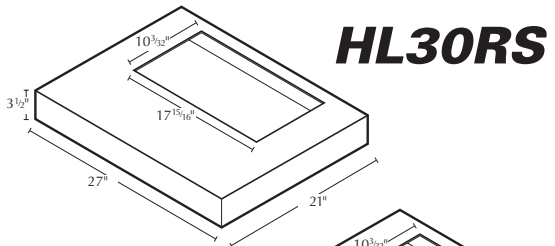
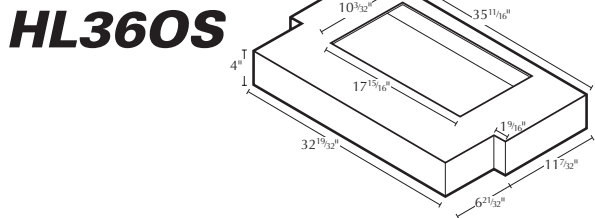
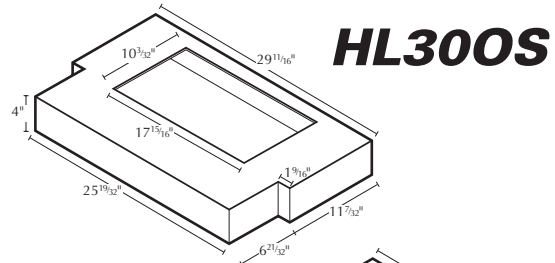

<b>PROJECT</b>							<b>ARCHITECT</b>			
<b>LOCATION</b>							<b>ENGINEER</b>			
<b>CONTRACTOR</b>							<b>SUBMITTED BY</b>			<b>DATE</b>
<b>FAN NUMBER</b>	<b>MODEL NUMBER</b>	<b>CFM</b>	<b>IN W.C.</b>	<b>RPM</b>	<b>WATTS</b>	<b>AMPS</b>	<b>SONES</b>	<b>QTY</b>	<b>OPTIONAL EQUIPMENT &amp; REMARKS</b>	

**U.S.:** 820 Lincoln Drive  
 West Chester, Pennsylvania 19380-4466  
 Tel: (610) 692-7400 • 877-304-3785  
 Fax: (610) 696-8048

**Canada:** 110 Glidden Road  
 Brampton, Ontario L6T 2J3  
 Tel: (905) 456-2033  
 Fax: (905) 456-1015